

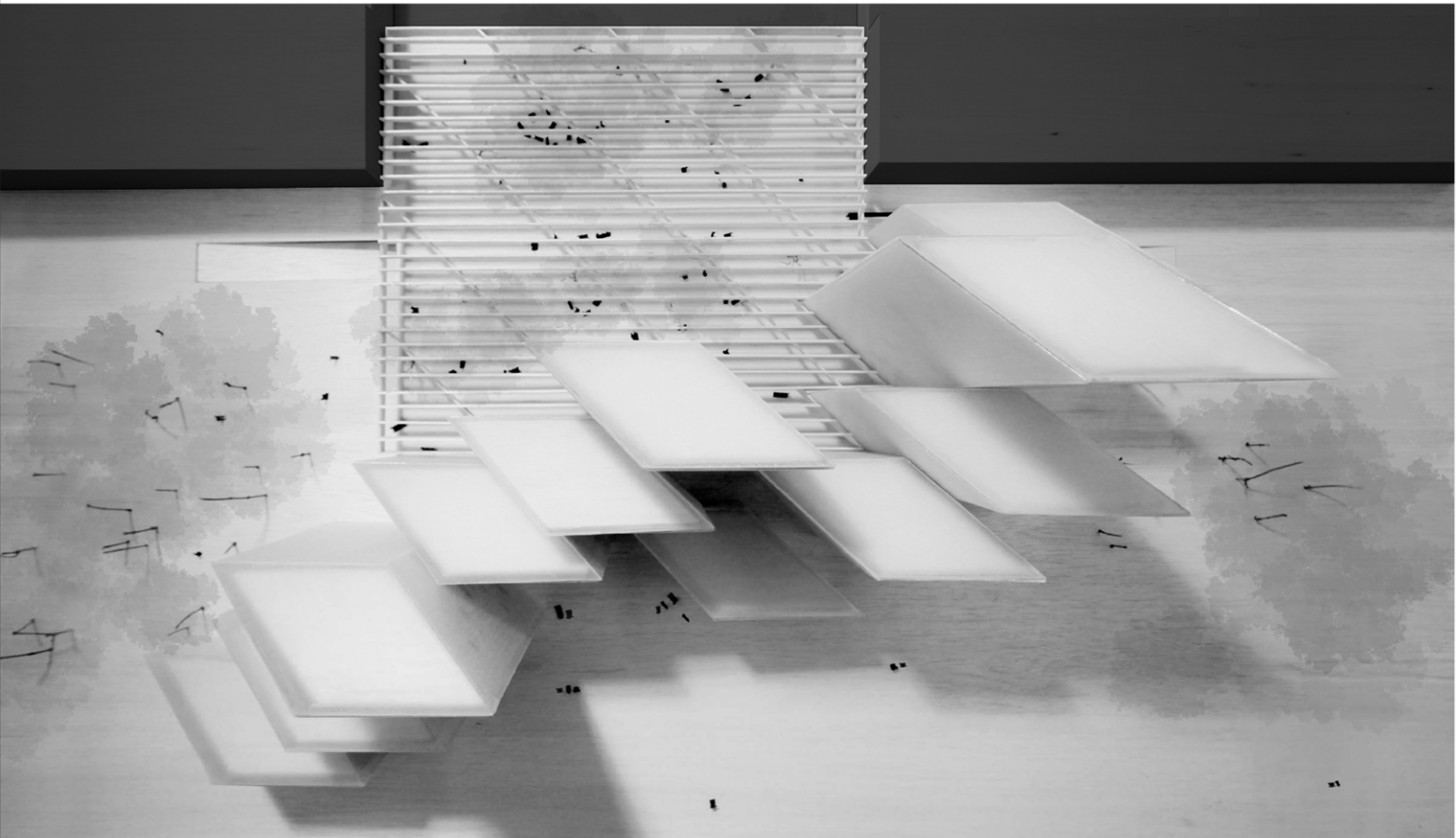

SOUTH EAST ELEVATION 1:200 0 2 4 10



SITE PLAN 1:500 0 2 4 10

CENTRE FOR PROMOTION OF SCIENCE OF THE REPUBLIC OF SERBIA

050304MS

A door opened to the future

Once established the need of a big scale intervention whose scale makes it identifiable from the Arsenija Carnojeveca Boulevard, we consider essential to join the strengths of both, the CFPOS and The Science Centre to create a grand urban event. Being the competition an attempt to locate Belgrade as a modern European city, the new centre must become an icon, a "door opened to the future" shown to the visitors in their access to Belgrade along the motorway E75. The crystalline volumes intend to show the science as pure and open knowledge, as it reminds us how its study can lead to a most elevated world, a space close to sky heaven. No human conquest is greater than height! We imagine huge quartz glasses projecting light to space as a representation of the scientific world.

Together but detached

The brief proposes the Science Institute's tower as the image representing the project. In our understanding this is not totally logical, and we propose instead to split the program in eleven smaller towers. Oh, san Gimignano! The volumes lay and connect to each other to house inside a series of spaces with no structural barriers if required. We avoid therefore the problem of how much we can build now and when will be extended. As a series it can be extended, modified at any time even after its completion, allowing interchanges between the two programs according to their own expansion. The geometry is generated in plan by squares deformed by the movement of cars. The volumes step back to show their gable to the motorway, as a sensitive response to the access to the city like welcoming visitors. This kinetic appearance produces different perceptions of the project from every side. The volumes are sharp to northwest and southeast and flat to northeast and southwest, showing an always changing image swinging between unity and fragment. There are not two equal sides.

The Science garden

We understand the science garden asked for in the brief as a cross between nature and construction, being some sort of waiting room. Our proposal incorporates a big concrete pergola as a protection against sun and rain, where different uses can be combined. Exhibition areas with meeting points, landscaped areas with circulation. Its location makes it a quiet place, far from the motorway. The rest of the plot is netted by pedestrian paths and will welcome the recuperation of most existing trees.

About the construction

The organization of the program in height allows a vertical circulation with mechanical means. Exhibitions are located in the first 5 floors and are separated in different rooms to different themes. Mechanical stairs will reinforce the link between them. Science club and offices will occupy smaller spaces in the highest volume, which will be crowned by a restaurant at 46 meters above ground opened out to the views of Belgrade. The towers are slim tubular structures laying to each other and built with thin grey concrete walls where gaps for light are cut out from when needed. The structure is covered by a laminated glass screen forming a ventilated and insulated facade which uses the sun's radiation to provide a fix selective translucent sunscreen according to the different seasons. Technical rooms are located underground to accommodate ground source heat pumps.